

CORDLEY



BUILDING LIMITATIONS

gym is not secured from the rest of the school for after hours activities and does not have publicly accessible restrooms

cafeteria and gym share same space, limiting the school's ability to have a flexible schedule and accommodate large group break-out

warming kitchen is too small to prep all food on site and accommodate dish washing facilities

clinic does not meet district square footage norms

insufficient resource room space across the school to work in small intervention groups

size of office too small to serve visitors needs and ensure secure access to the building

classroom areas are in the low range of that needed for 21st century learning models

classrooms do not meet district square foot norms nor do they accommodate 21st century learning models

all rooms in the original building do not meet ADA standards

the gifted room shares a space with the boys and girls club office and storage and does not provide an ideal learning environment

library is does not meet district square footage norms

SPED rooms do not provide adequate space for group, individual and sensory therapy; in addition SPED rooms do not have required adjoining restrooms and storage

the conference room is located in the book room, an inadequate space to take parents for meetings

lounge and workroom share one room

main office does not have a view of the main entrance

SPACE NEEDS

- _media lab
- _group rooms
- _parent room
- _commuity/pto space
- _public restroom

FACILITIES LIMITATIONS

- _classrooms lack electrical outlets and telecommunications infrastructure
- _HVAC system needs to be updated with more control for individual rooms
- _restrooms need to be outfitted with automatic fixtures
- _teachers and staff need more control over light levels in classrooms

SITE LIMITATIONS

LOT: 3.46 acres

HARD PLAYGROUND: 0.34 acres

SOFT PLAYGROUND: 0.25 acres

FIELDS: 1.30 acres

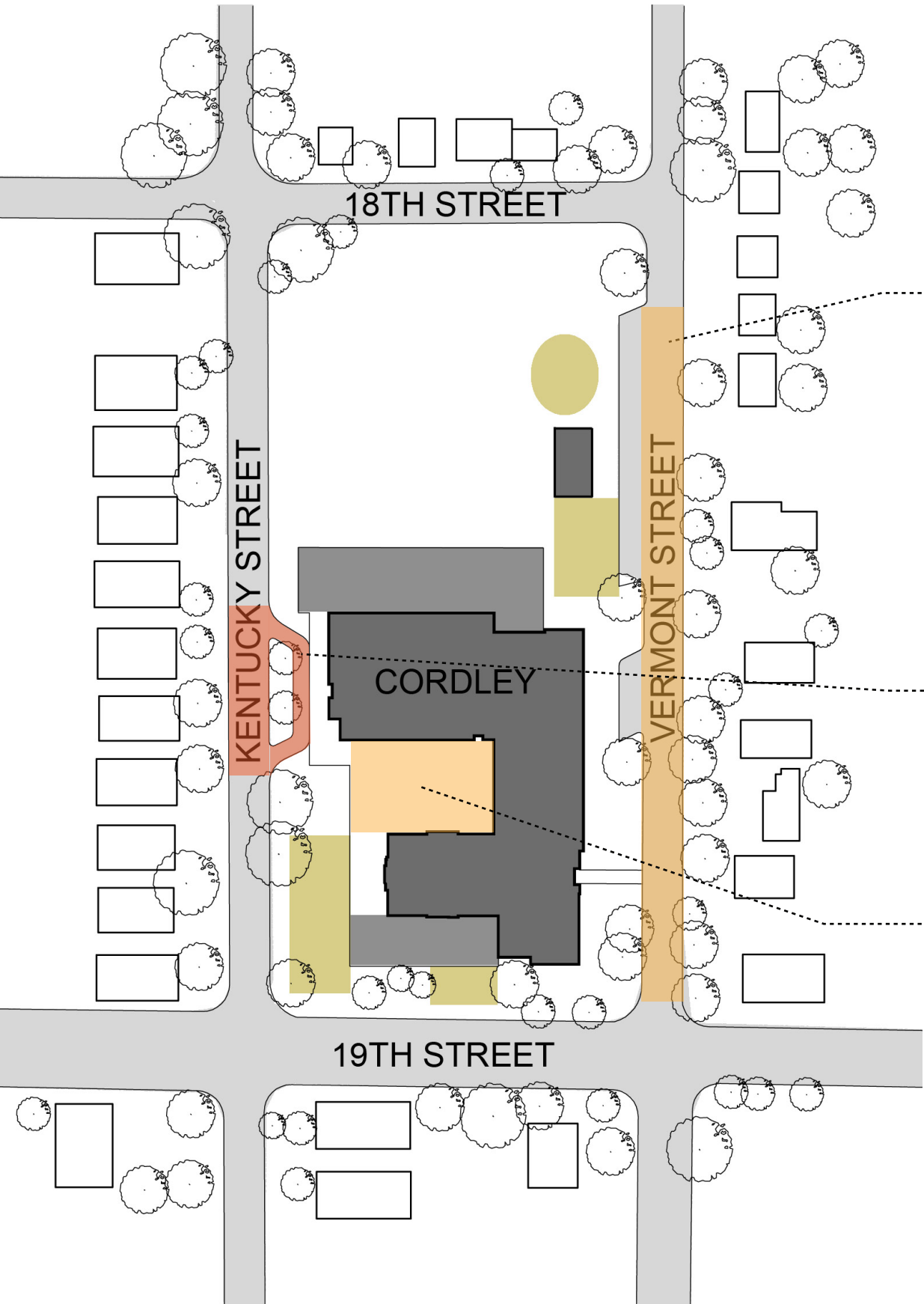

pick-up and drop-off on Vermont St. does not provide adequate safety for children coming or going from cars

buses double park in the pick-up and drop-off lane, while others park on the street, this is a major safety issue

staff parking is insufficient so staff are left to park on neighborhood streets

POTENTIAL IMPROVEMENTS

PRIORITY 1: REPLACEMENT OF PORTABLES AND SHARED GYM AND CAFETERIA

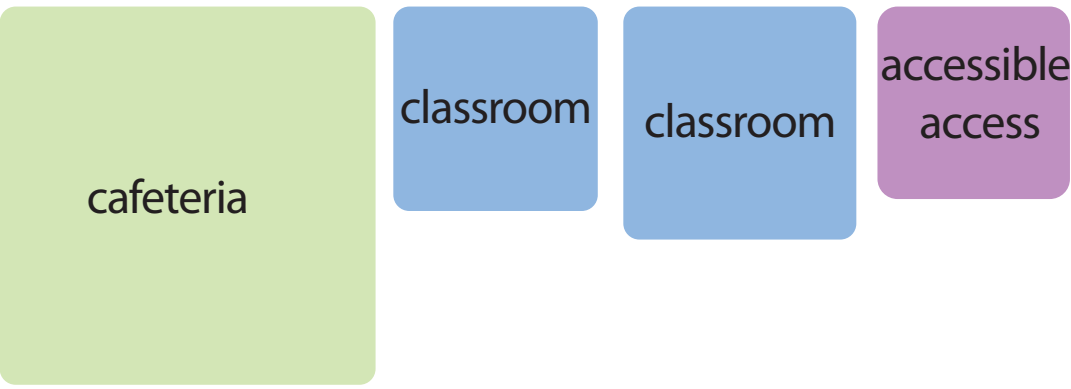

PRIORITY 2: INCREASE OF SQUARE FOOTAGE TO MATCH THE UPPER RANGE IN THE DISTRICT

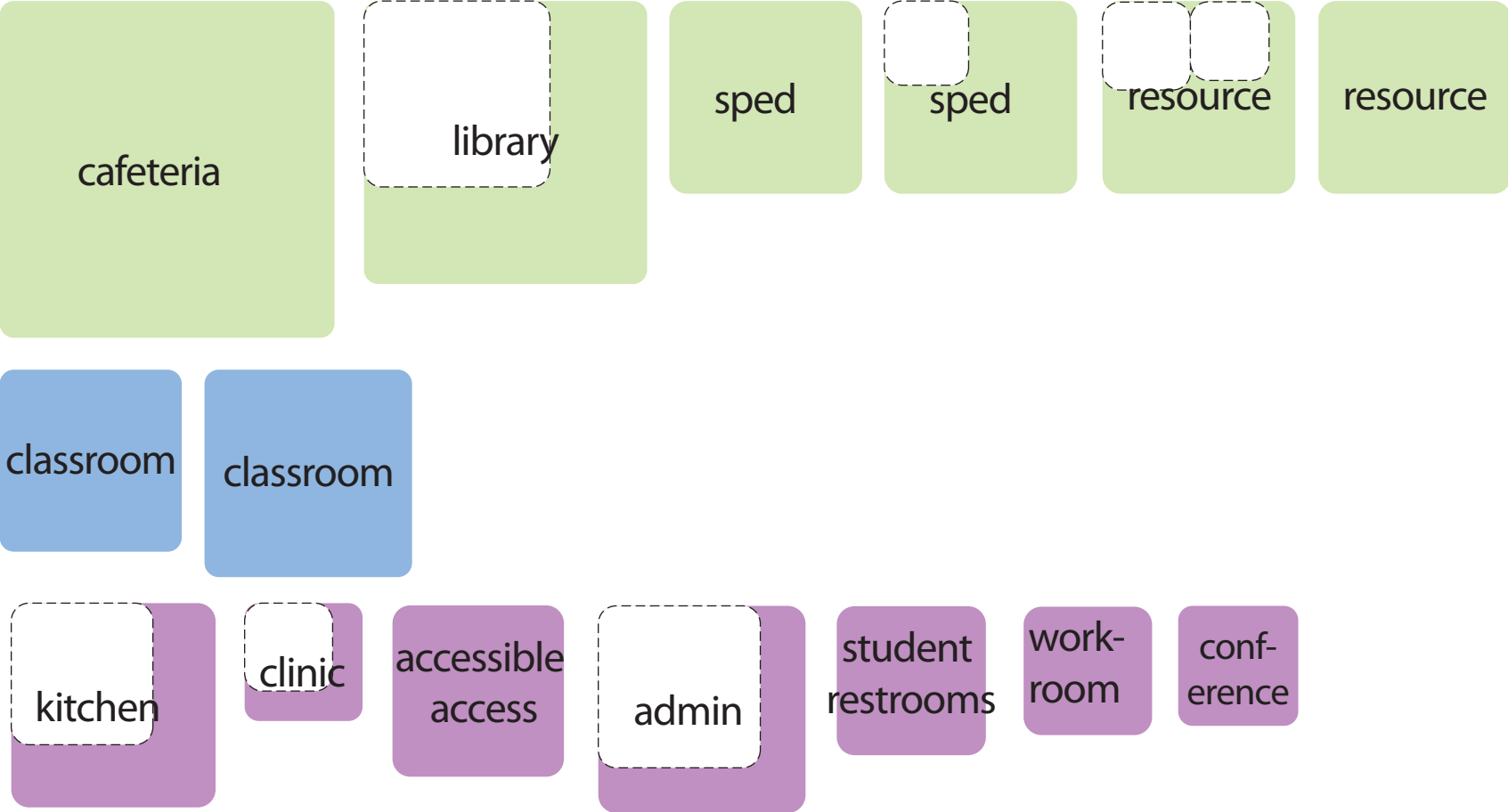

PRIORITY 3: INCREASE OF SQUARE FOOTAGE TO MEET NATIONWIDE STANDARDS FOR NEW CONSTRUCTION

