

HILLCREST



BUILDING LIMITATIONS

SPED rooms do not provide adequate space for group, individual and sensory therapy; in addition SPED rooms do not have required adjoining restrooms and storage

classrooms do not meet district square foot norms nor do they accommodate 21st century learning models

music and art rooms do not meet district square foot norms

cafeteria and gym share same space, limiting the school's ability to have a flexible schedule and accommodate large group break-out

gym is not secured from the rest of the school for after hours activities and does not have publicly accessible restrooms

warming kitchen is too small to prep all food on site and accommodate dish washing facilities

restrooms need renovation to provide proper fixtures

classroom areas are in the low range of that needed for 21st century learning models

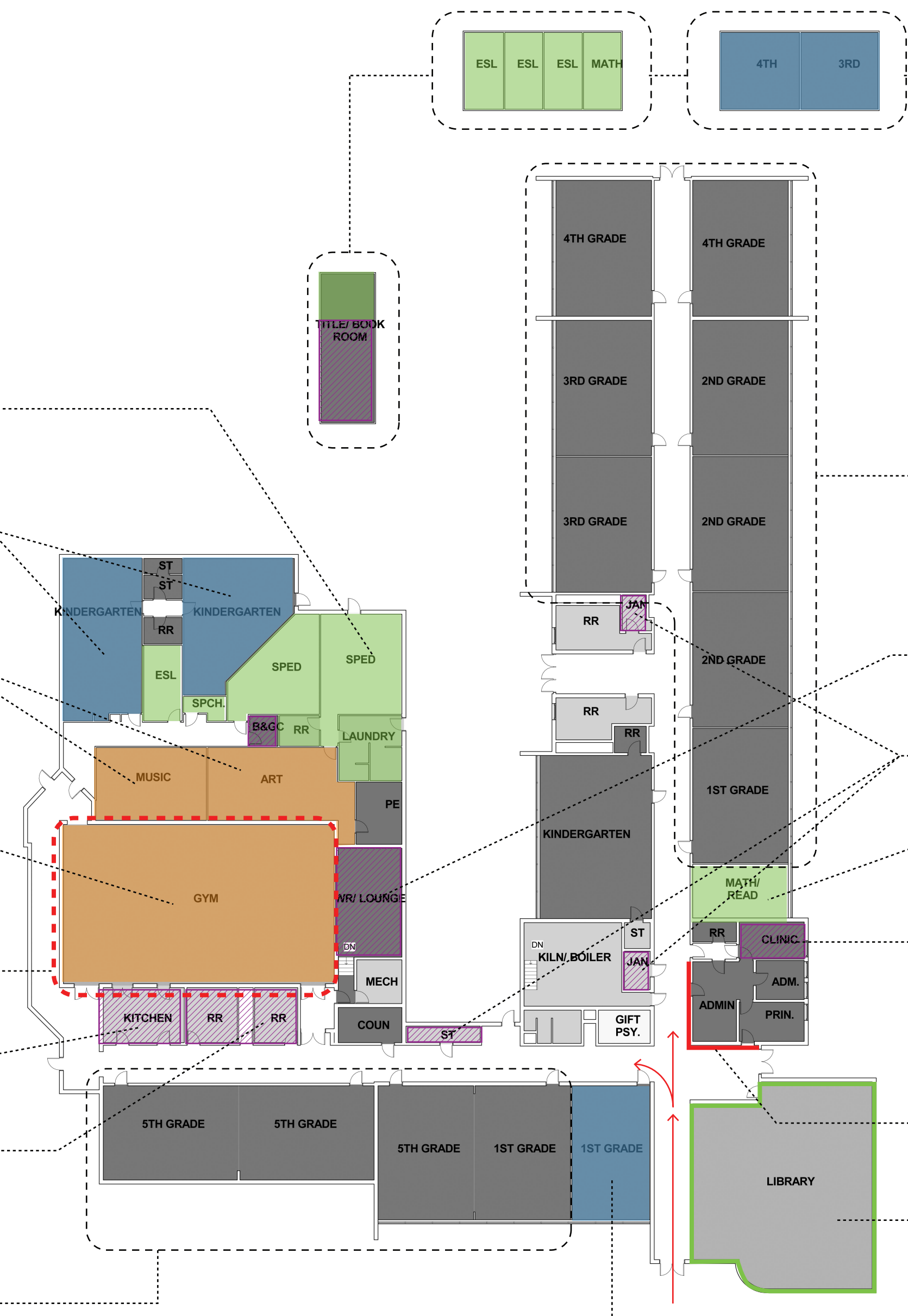

portables do not provide equitable learning environments

classroom areas are in the low range of that needed for 21st century learning models

stage is used as a workroom and lounge

custodial spaces are inadequate

title and resource spaces are insufficient in number and limit instructors abilities to hold break out groups

clinic does not meet district square foot norms

main office does not have a view of the main entrance

computer lab and library do not provide up-to-date technologies to supplement 21st century education

classroom does not meet district square foot norms nor does it accommodate 21st century learning models

SPACE NEEDS

- _media lab
- _group rooms
- _conference room
- _public restroom
- _community/pto space
- _gifted room

FACILITIES LIMITATIONS

- _classrooms lack electrical outlets and telecommunications infrastructure
- _HVAC system needs to be updated with more control for individual rooms
- _restrooms need to be outfitted with automatic fixtures
- _teachers and staff need more control over light levels in classrooms

SITE LIMITATIONS

LOT: 5.46 acres

HARD PLAYGROUND: 0.54 acres

SOFT PLAYGROUND: 0.16 acres

FIELDS: 2.11 acres

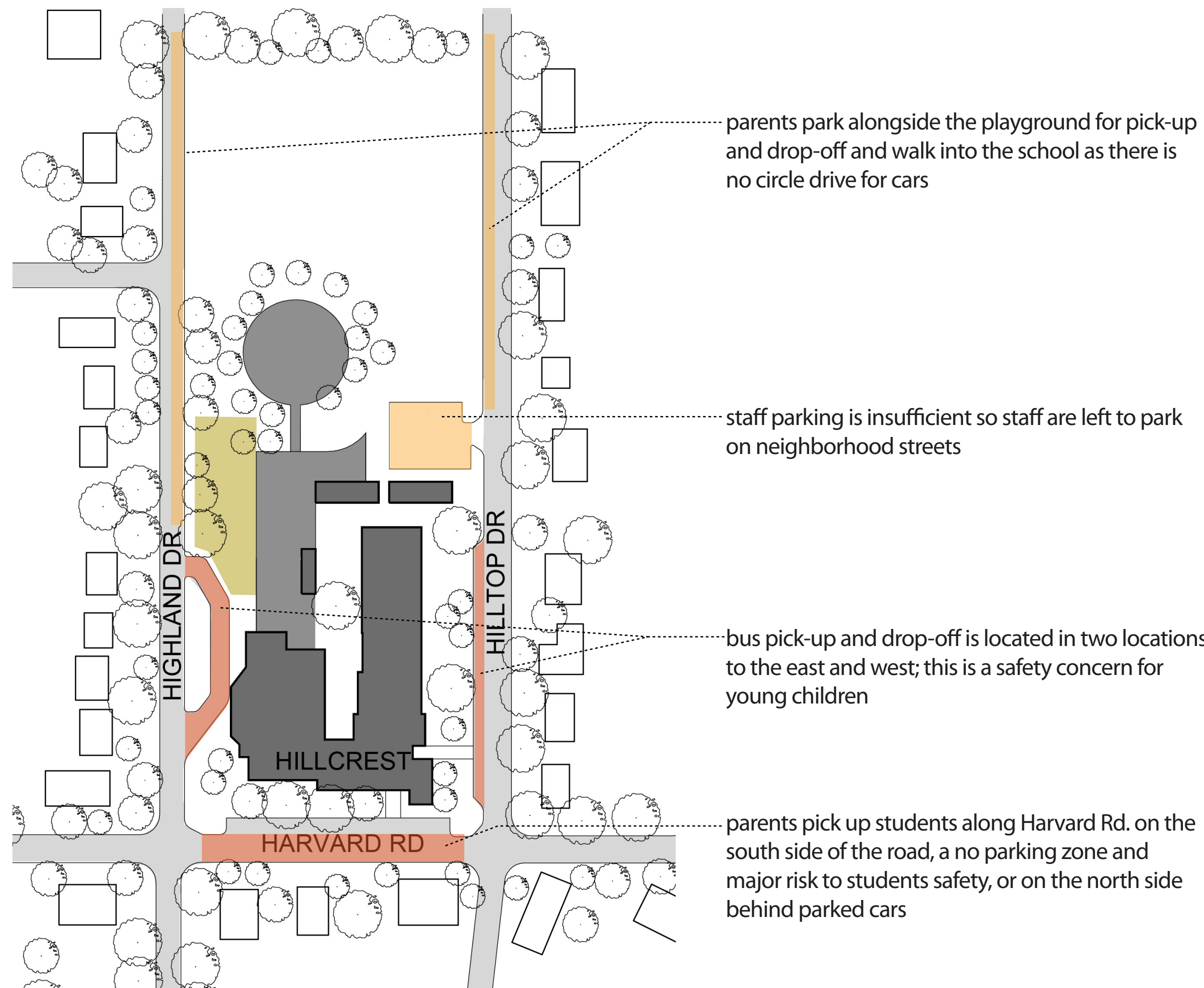

parents park alongside the playground for pick-up and drop-off and walk into the school as there is no circle drive for cars

staff parking is insufficient so staff are left to park on neighborhood streets

bus pick-up and drop-off is located in two locations, to the east and west; this is a safety concern for young children

parents pick up students along Harvard Rd. on the south side of the road, a no parking zone and major risk to students safety, or on the north side behind parked cars

POTENTIAL IMPROVEMENTS

PRIORITY 1: REPLACEMENT OF PORTABLES AND SHARED GYM AND CAFETERIA

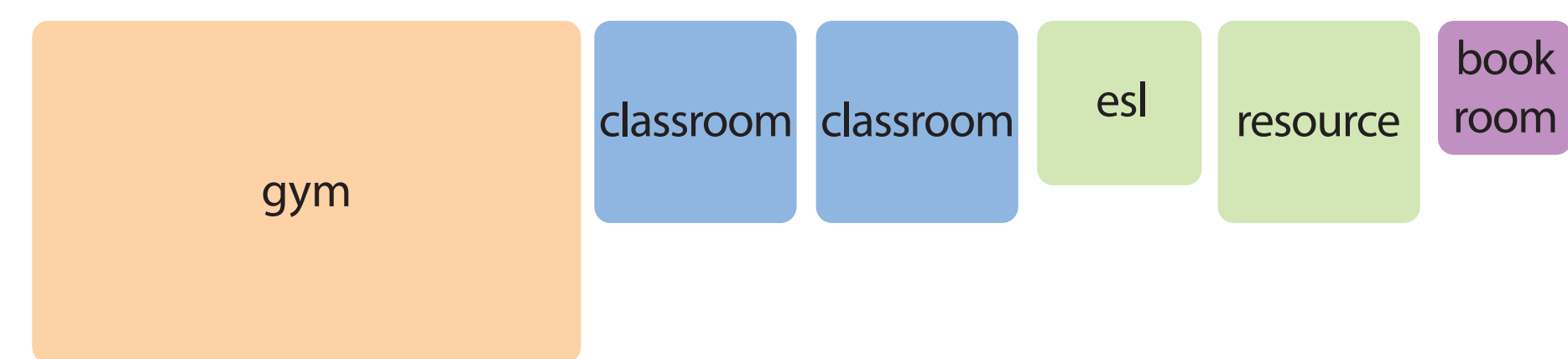

PRIORITY 2: INCREASE OF SQUARE FOOTAGE TO MATCH THE UPPER RANGE IN THE DISTRICT

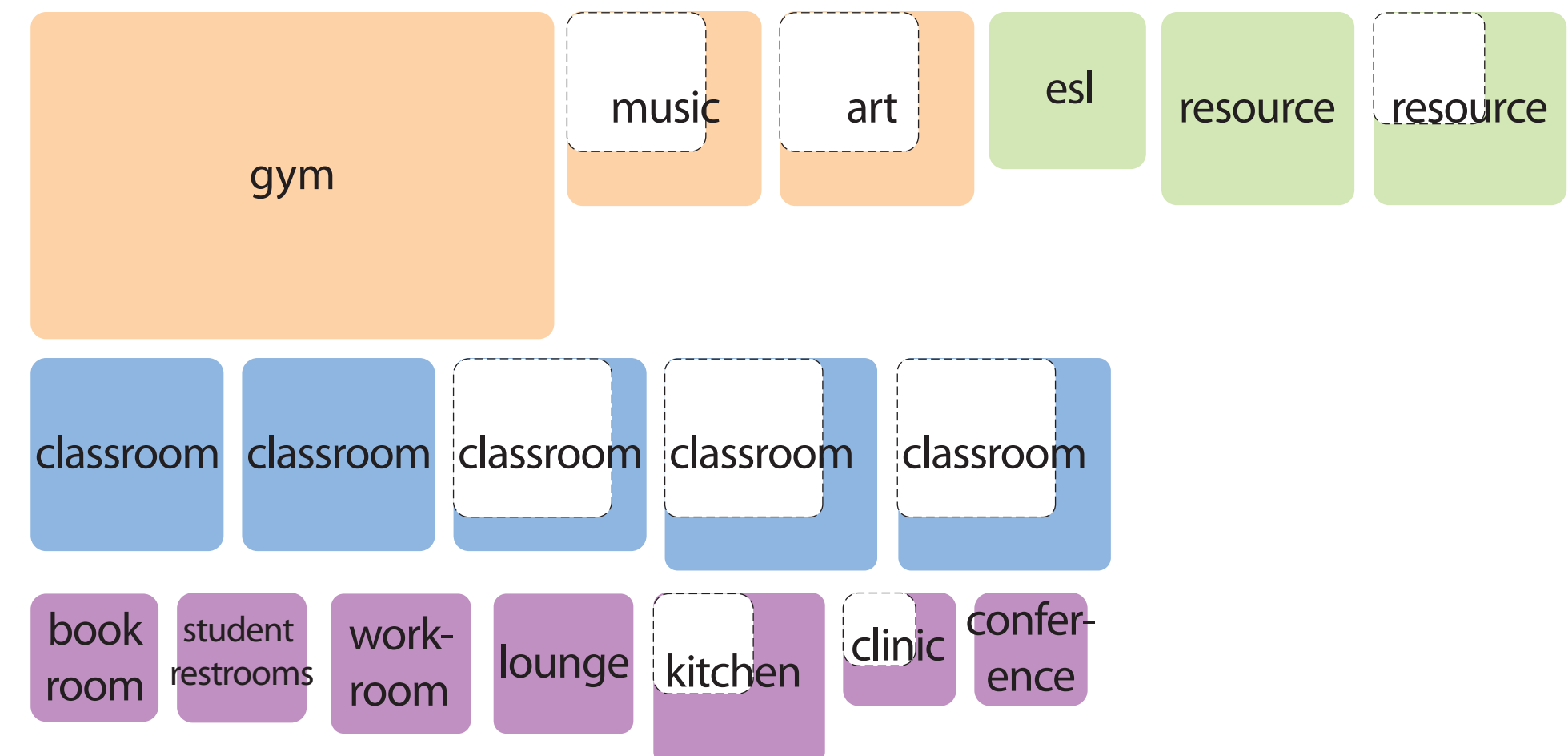

PRIORITY 3: INCREASE OF SQUARE FOOTAGE TO MEET NATIONWIDE STANDARDS FOR NEW CONSTRUCTION

